



# CITY OF LACKAWANNA DEPARTMENT OF DEVELOPMENT

714 Ridge Road – Room 309  
Lackawanna, NY 14218  
Tel: (716) 827-6421 Fax: (716) 827-1866



## APPLICATION TO THE CITY OF LACKAWANNA ZONING BOARD OF APPEALS

Date: 2/10/20

Application No. \_\_\_\_\_

Application Fee:	Fee
<u>      </u> Land Use Variance	\$ 100.00
<u>  X  </u> Zoning Law Appeal	\$ 100.00

Property Address: 3254 South Park Ave

S.B.L. No. 140900 142.18-3-2

Description of Action to be Appealed: Trailer + Auto Sales

Send Notice of Hearing to Applicant at  
310 Seneca Creek Rd, West Seneca 14224  
tel (716) 800-5830 - Send PB App.

APPLICATION IS HEREBY MADE to the City of Lackawanna Zoning Board of Appeals for a Land Use Variance and/or Zoning Law Appeal as required by the Municipal Code of the City of Lackawanna. The applicant hereby agrees to comply with all applicable laws, rules, ordinances and regulations.

Richard Stanton  
Director of Development

**EXISTING SITE PLAN**  
SCALE: 1" = 30'-0"

**SITE NOTES**

PROPERTY:	0.217 ACRES
ZONING:	NEIGHBORHOOD COMMERCIAL
EXISTING BUILDING:	1,614 SF
GREEN AREA:	0.03 ACRES

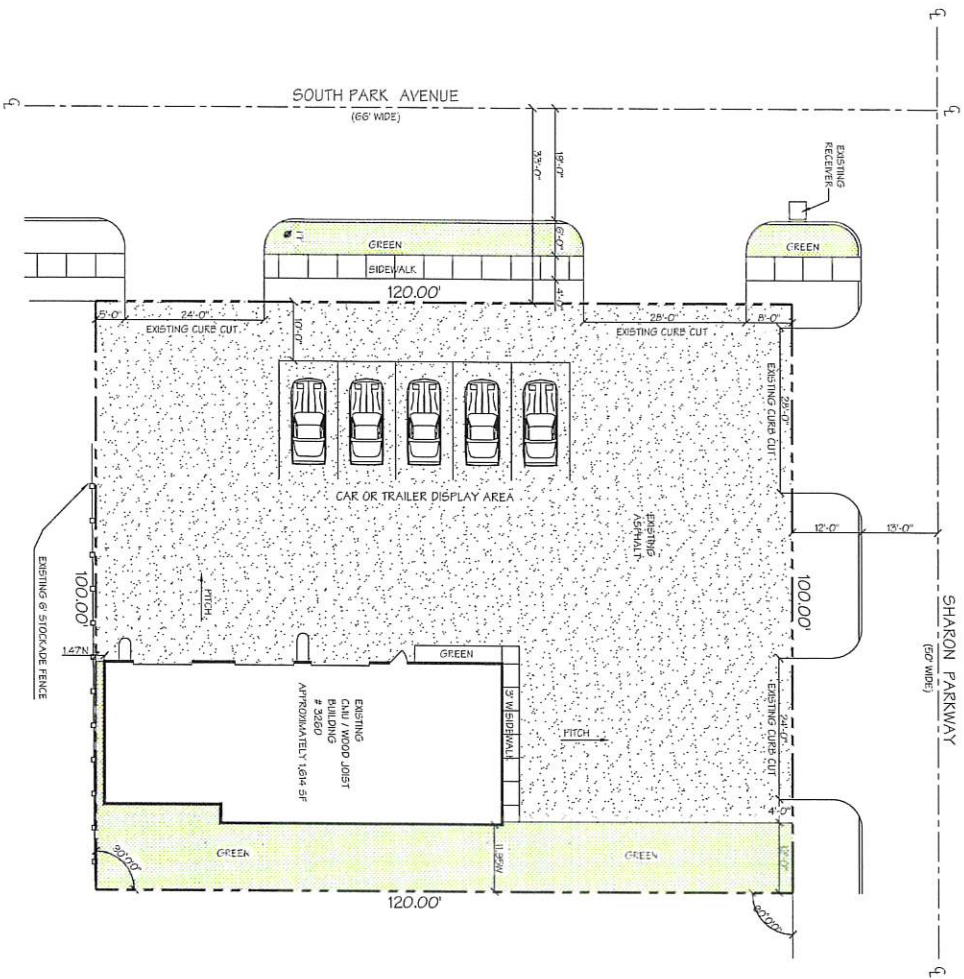

**LOCATION MAP**  
SCALE: 1" = 100'-0"

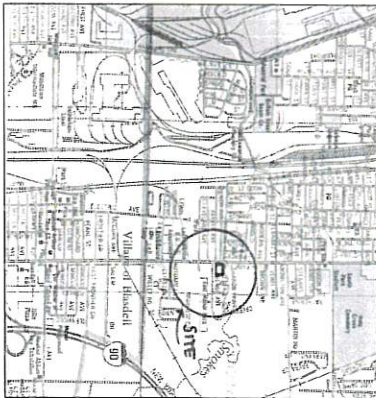

3260 SOUTH PARK AVENUE, LACKAWANNA



Project No. 1111  
 Drawing No. SP-1  
 Date: 09/14/2020

**SITE PLAN**

**MIKE SMITH CAR SALES PROJECT**  
 3260 SOUTH PARK AVENUE  
 LACKAWANNA, NEW YORK

**F. J. WALL AND ASSOCIATES, INC.**  
 ENGINEERING FOR TRANSPORTATION  
 1000 WEST RIVER ROAD  
 SUITE 200  
 LACKAWANNA, NY 14101

**JAMES TULLER PROPERTY**  
 5729 EAST RIVER ROAD  
 GRAND ISLAND, NY 14072

**Revising Remarks**

No.	Date	By	Remarks

This document is the exclusive property of F. J. WALL AND ASSOCIATES, INC. NO PARTS OF THIS DOCUMENT OR ANY INFORMATION CONTAINED HEREIN MAY BE REPRODUCED OR TRANSMITTED IN ANY FORM OR BY ANY MEANS, ELECTRONIC OR MECHANICAL, WITHOUT THE WRITTEN PERMISSION OF F. J. WALL AND ASSOCIATES, INC. ALL PROJECT ASSOCIATES SHALL BE RESPONSIBLE FOR OBTAINING ALL NECESSARY PERMITS AND APPROVALS FROM THE APPROPRIATE AGENCIES.